

Notes:

1. If drywall or another material is being installed over the face of the framing (by others) prior to the panel installation then the ROs are based on whatever surface we're attaching our panels to.
2. A minimum height of 18'6" is required for the finished ceiling height; nothing can be lower than this dimension per the WSF. The 20'0" height shown is a common finished height.

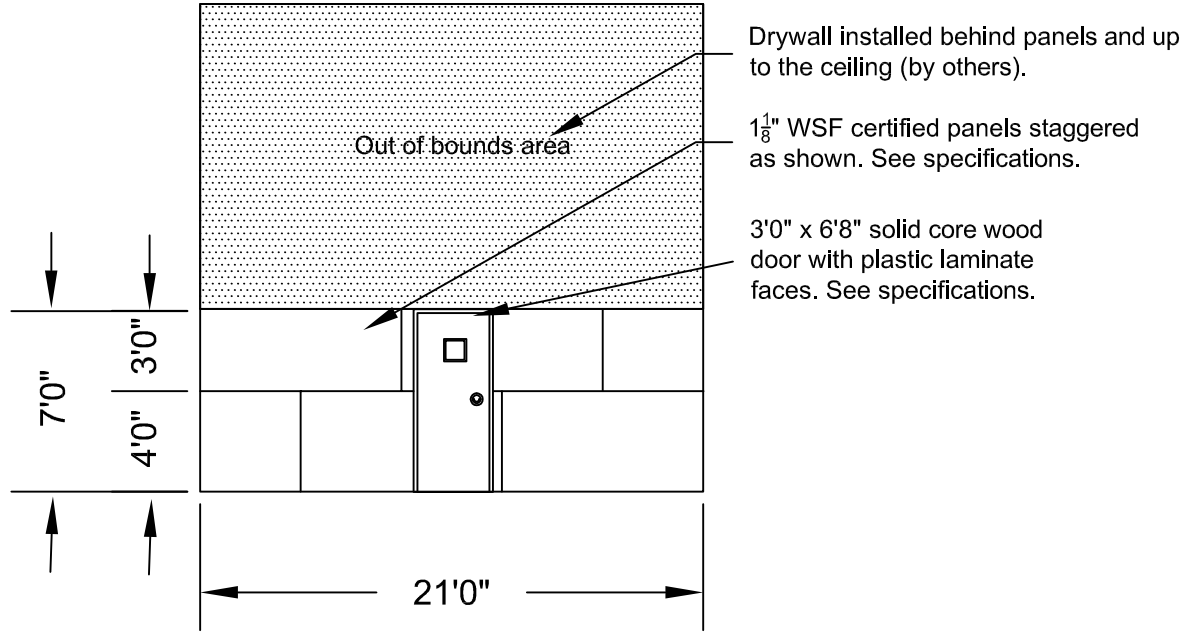

Drywall installed behind panels and up to the ceiling (by others).

1 1/8" WSF certified panels staggered as shown. See specifications.

3'0" x 6'8" solid core wood door with plastic laminate faces. See specifications.

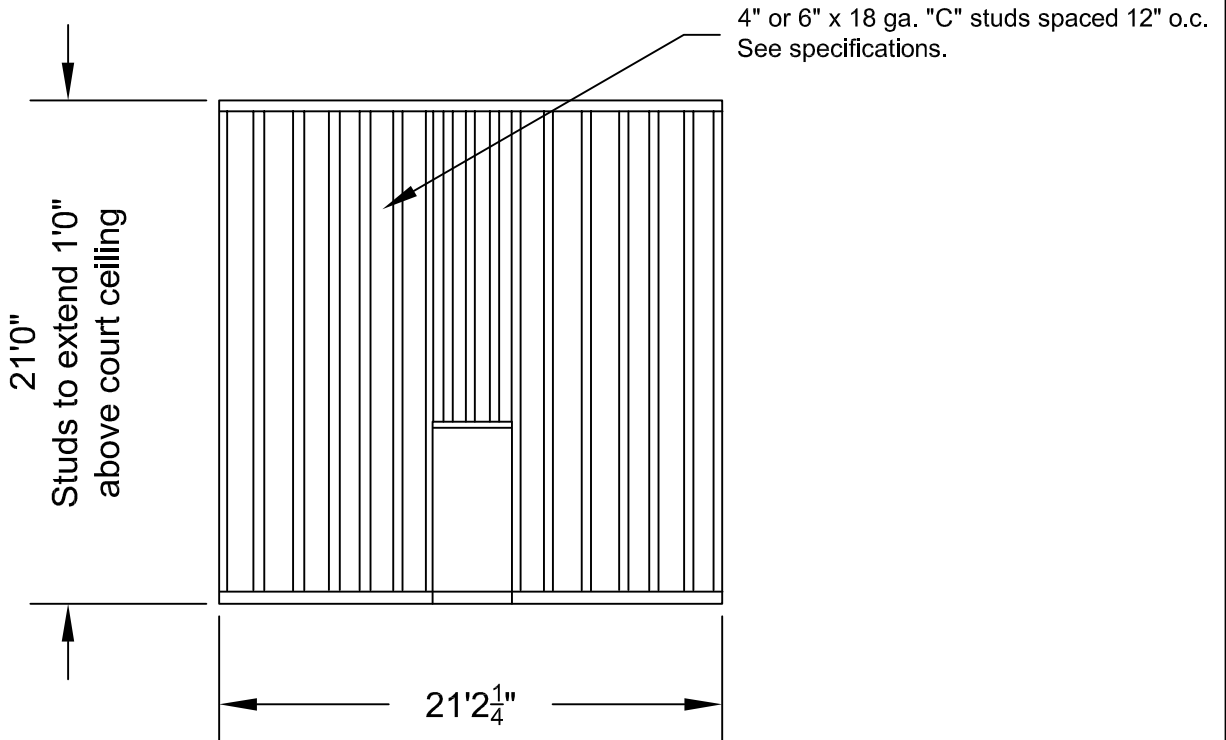

4" or 6" x 18 ga. "C" studs spaced 12" o.c. See specifications.

21'0"
Studs to extend 1'0" above court ceiling

Check here if framing is by others.



The Court Company
3059 Forest Hill-Irene Road
Germantown, TN 38138 USA

Drawings are submitted for review for contracted project and are to be used accordingly.
Drawings are not to scale.

Typical Rear Wall Details (WSF)

Page